

INSTALLATION INSTRUCTIONS

DESCRIPTION: GYTR Billet Pressure Plate
PART NUMBER: BR8-E63B0-V0
MODEL: '18 ~ YZ65



⚠ WARNING

Please read and understand these instructions completely before installation to avoid possible injury, or damage to the accessory or vehicle.

NOTICE:

This installation requires a torque wrench and the Service Manual for the model. It should be performed by an authorized Yamaha dealer or other qualified technician.

WARRANTY INFORMATION:

See your Yamaha dealer for a copy of the Yamaha Genuine Parts and Accessories Limited Warranty Statement.

DEALER OR INSTALLER:

These instructions contain important information for future reference and *must* be given to the customer.

PARTS LIST:

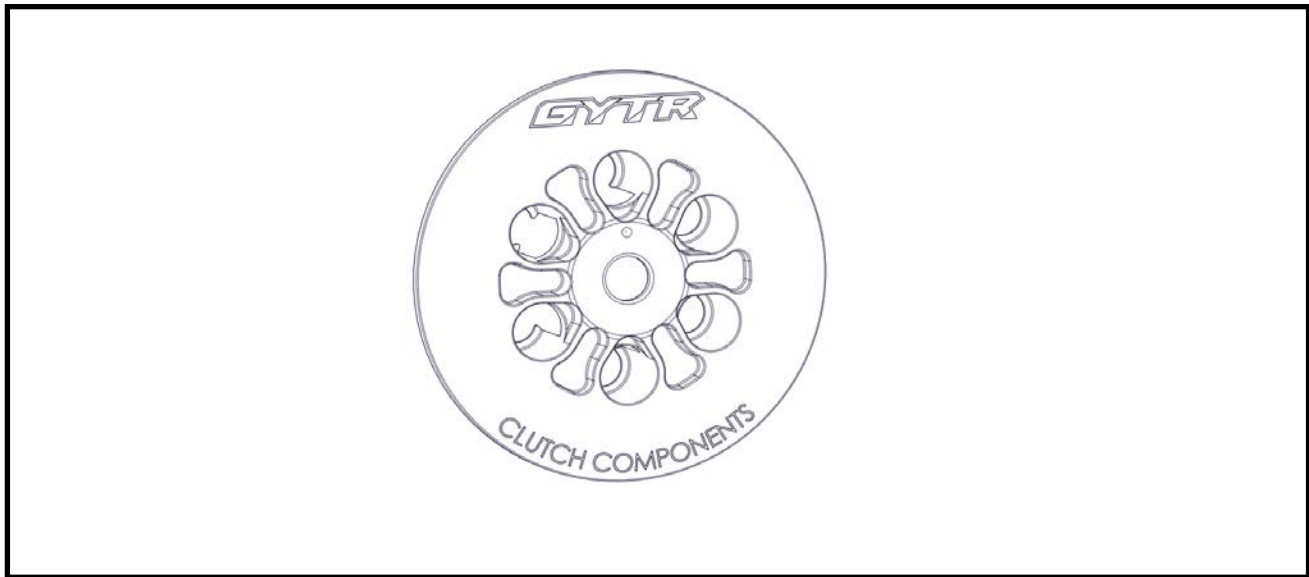

No.	Part Number	Description	Qty
①	BR8-E63B0-V0-00	GYTR Billet Pressure Plate	1

* Part supplied with kit only and not available separately.

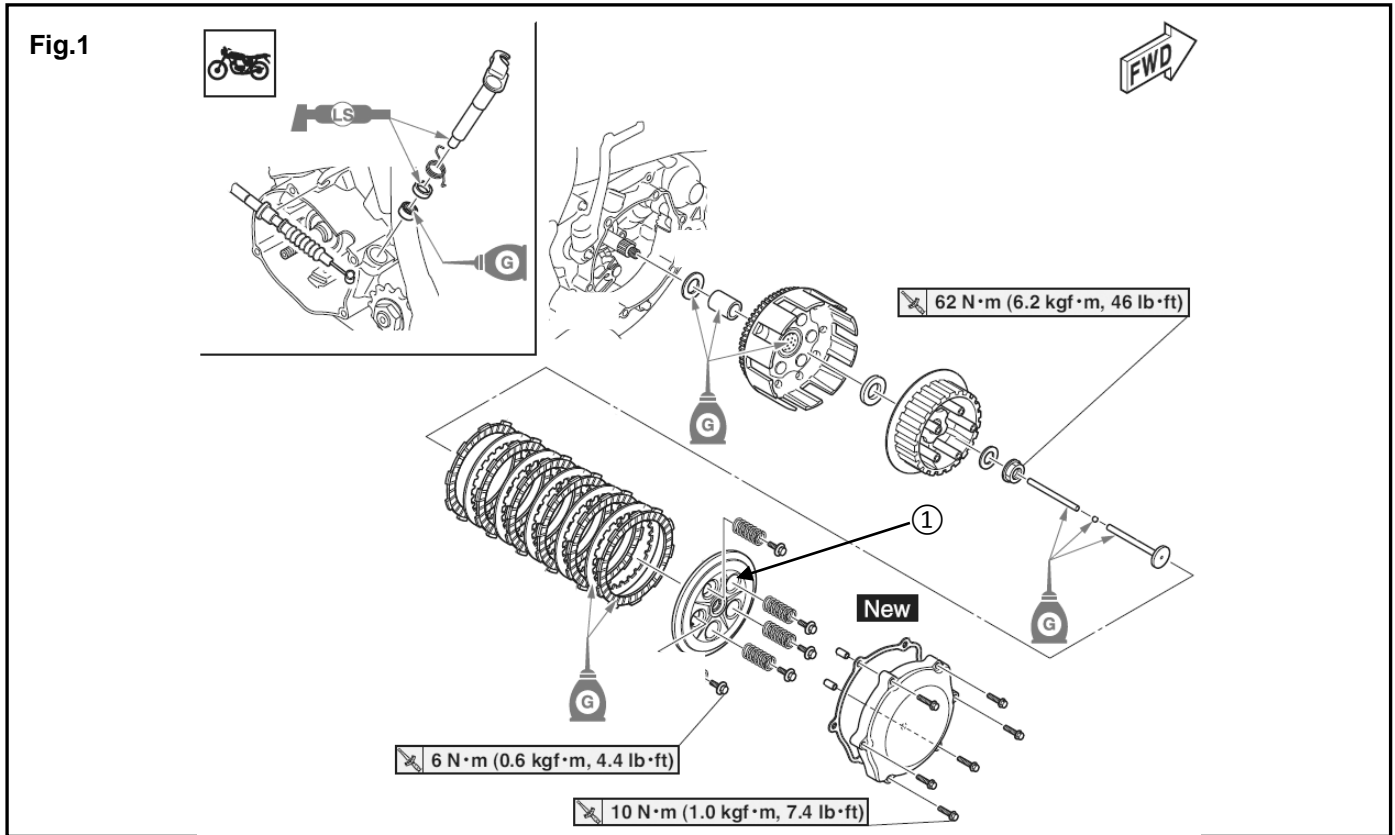

PREPARATION:

- Stand the motorcycle on a secure and level surface, and drain oil.
- Alternately, lean the motorcycle on its left side and complete the installation without draining oil.
- Clean all mounting surfaces before beginning installation.

INSTALLATION:

Use the Owner's Service Manual as a guide for disassembly and reassembly. **Note:** You may need a new clutch cover gasket (p/n 5PA-15463-00-00).

MAINTENANCE:

Periodically check all hardware for tightness and re-torque as necessary.

CUSTOMER SERVICE:

For further information see your Yamaha dealer.

ESTIMATED TIME TO INSTALL: 0.5 HRS